

## SYSTEM SP51033

Test No.	Fire rating level	Rw	C	CTR	Net acoustic rating	Thickness	51
RMIT 15-042A/JW	-/60/60	50	-3	-9	Rw+Ctr 41	121mm	

### System Composition

- 13mm wet area plasterboard
- 16mm steel batten
- 51mm Speedpanel® 750kg/m<sup>3</sup> density
- 28mm furring channel
- 25mm x 32kg/m<sup>3</sup> polyester insulation
- 13mm standard plasterboard

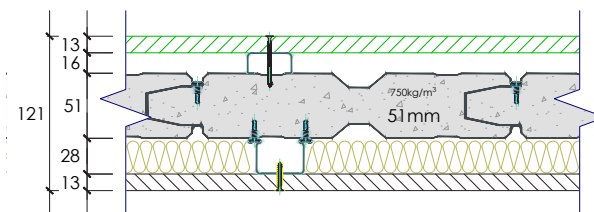

FREQUENCY (Hz)	Rw 50 REF. CURVE (dB)	SOUND TRANSMISSION LOSS (dB)
80	-	21.8
100	31	25.0
125	34	25.4
160	37	32.3
200	40	36.4
250	43	38.9
315	46	43.3
400	49	49.3
500	50	52.7
630	51	58.0
800	52	60.0
1000	53	60.8
1250	54	62.9
1600	54	62.5
2000	54	62.5
2500	54	63.0
3150	54	62.5
4000	-	65.8
5000	-	70.6

